

SNAP SAMPLER DEPLOYMENT (PAGE 1 OF 2)

INSERTING AND SECURING BOTTLES

Version 11-07

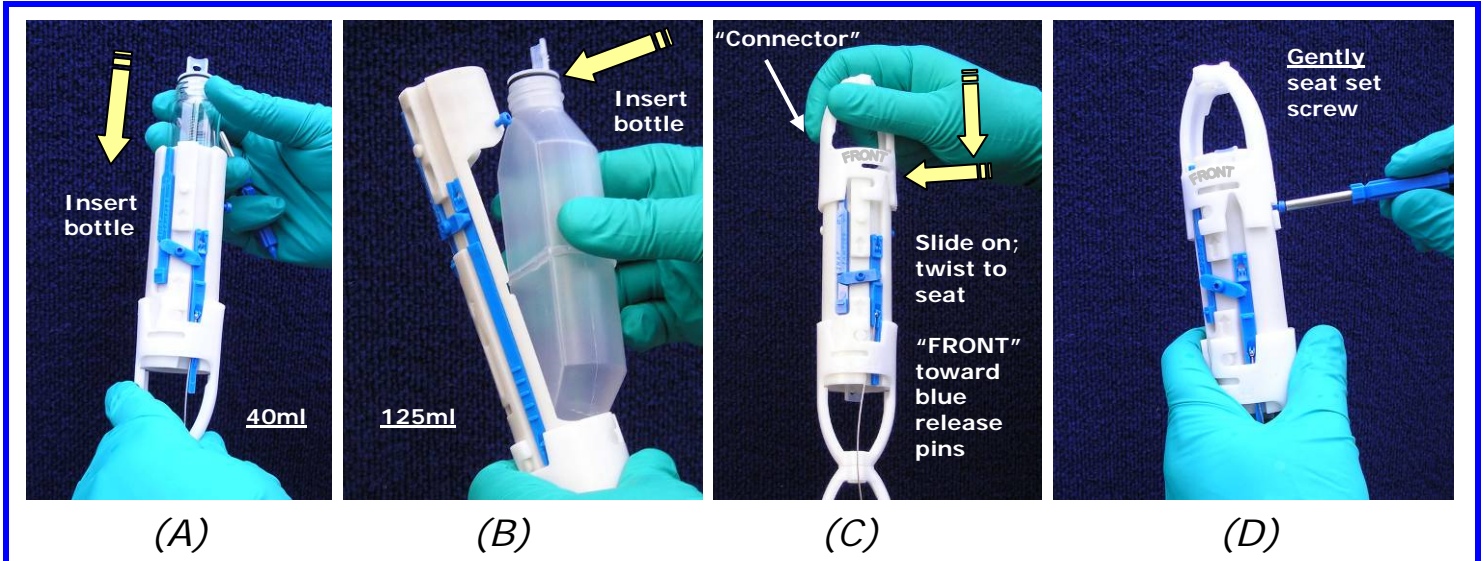

- A) Insert 40 ml VOA into top of 40 ml Snap Sampler ...or...
B) Insert 125 ml POLY into back side of 125 ml Snap Sampler.
C) Slide "Connector" over sampler and twist clockwise to seat.
D) Secure Connector and bottle with blue set screw.
E) Set All Bottom Snap Caps First, then Top Snap Caps. Insert Snap Driver blade into the upper hole of the concave side of Snap Cap (insert the driver past the tip, to the smooth part of the driver blade shaft); align driver handle with the release pin.
F) Push down on Snap driver handle to lift Snap Cap.
G) Pivot on the notch in the driver handle until driver handle is flush/parallel with sampler body and Snap Cap is in its seat; grasp driver or use thumb to push driver down so that fingers are kept clear of driver alignment with sampler body.
H) Use thumb of the hand holding the Sampler to push release pin up through lower hole in the Snap Cap; repeat "E" through "H" for each Snap Cap in all Samplers.

SETTING SNAP CAPS

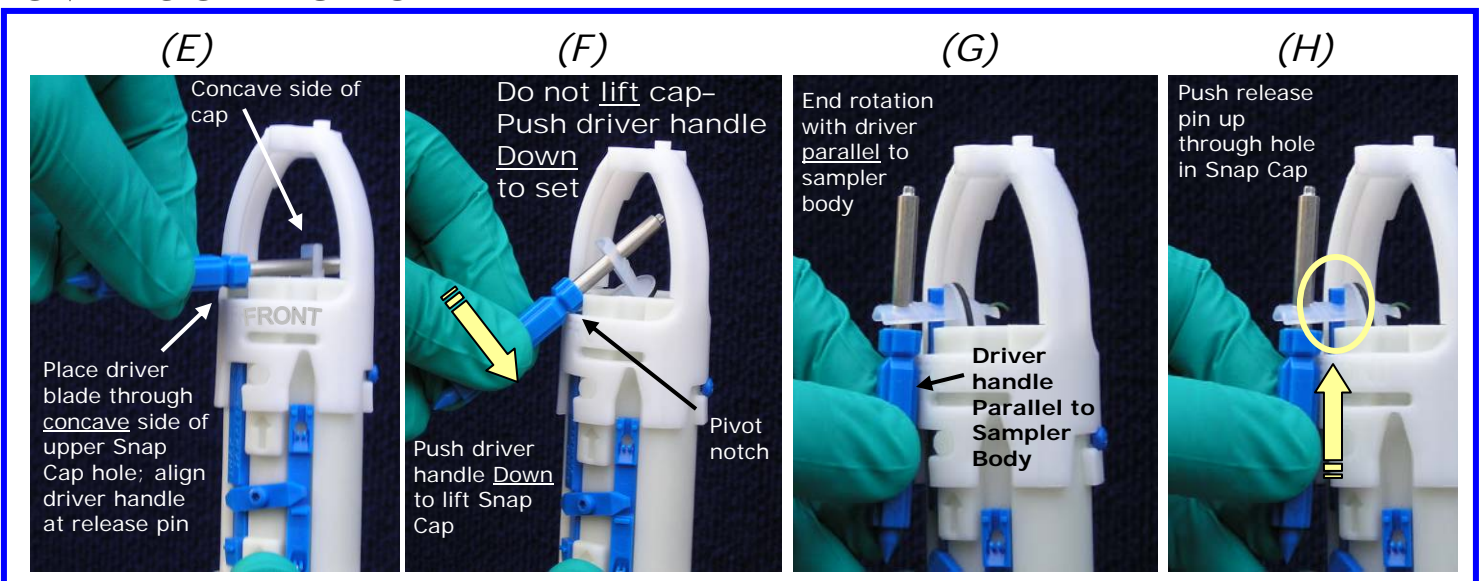

SNAP SAMPLER DEPLOYMENT (PAGE 2 OF 2)

ATTACHING TRIGGER

Version 11-07

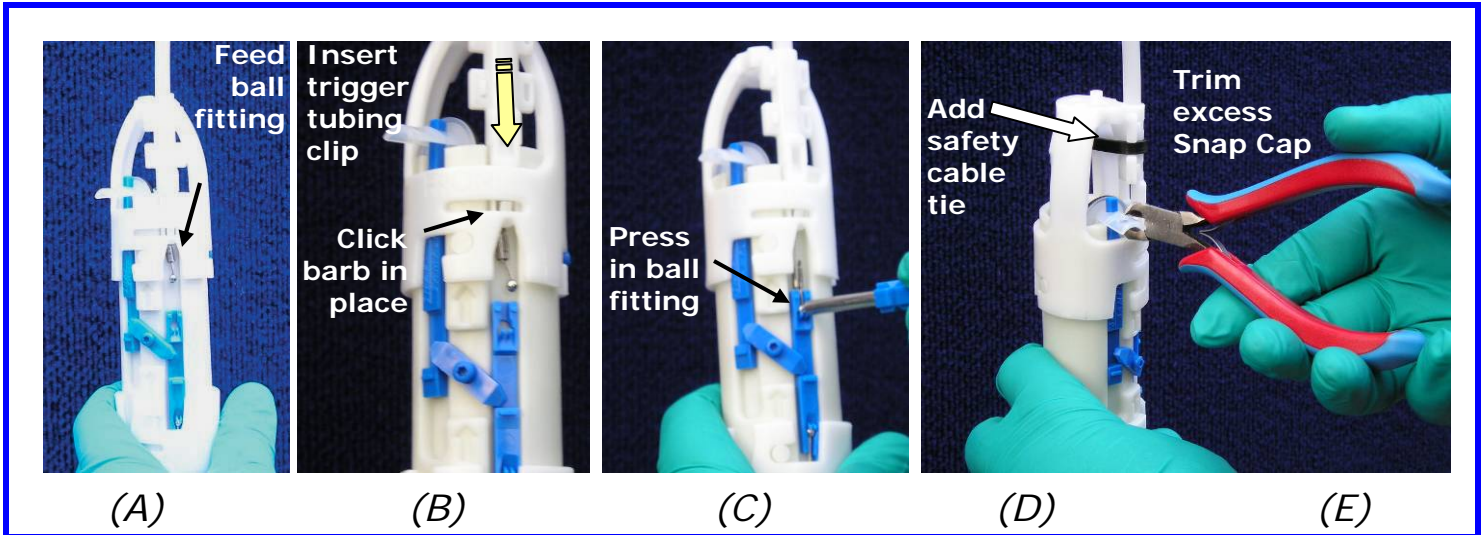

- A) Insert ball end of trigger in upper release pin groove.
- B) With **trigger barb facing out**, insert trigger until barb **clicks** into position.
- C) **Press ball fitting into release pin using dimple at end of Snap Driver.**
- D) Attach safety cable tie.
- E) Trim protruding Snap Caps between ribs (required for smaller diameter wells). Where more than one sampler is attached to one trigger, **connect ball-end connector cables between each sampler** (not shown).
- F) Lower Sampler to depth; seat trigger clip into ramp on Dock Ring.
- G) Close and lock well cap.
- H) To sample, **pull trigger cable while holding Dock Ring in place**; remove trigger from dock and retrieve samplers.

WELL HEAD DOCK ATTACHMENT

